



CAUTION

RISK OF ELECTRIC SHOCK
DO NOT OPEN

CAUTION : TO REDUCE THE RISK OF ELECTRIC SHOCK,
DO NOT REMOVE COVER
NOT USER SERVICEABLE PARTS INSIDE
REFER SERVICING TO QUALIFIED SERVICE PERSONNEL

Dimensions

Part name & Dimension

Smoke Detector

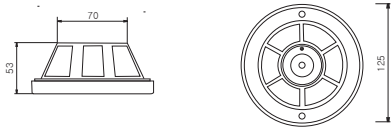

Clock Camera

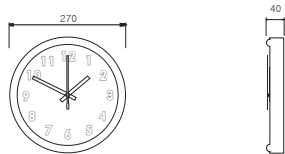

PIR Detector

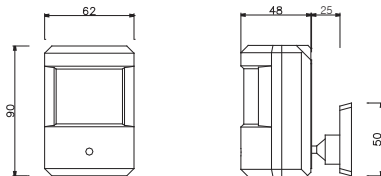

Accessories



Screws

Installation

Smoke Detector

Step.1

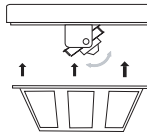

Step.2-1

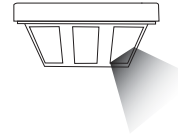

Step.2-2

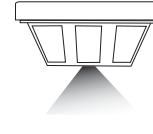

Clock Camera

Step.1



Step.2

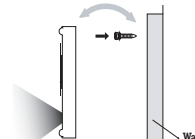

PIR Detector

Step.1

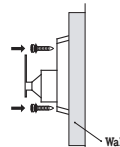

Step.2

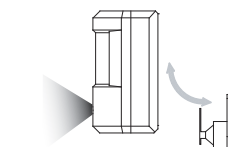

Basic Cable

Audio / Motion detector, Alarm option Cable

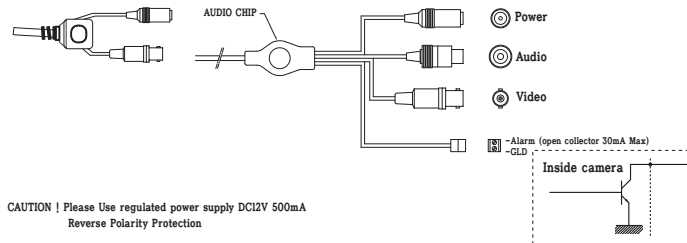

CAUTION ! Please Use regulated power supply DC12V 500mA
Reverse Polarity Protection

Specifications

TV System	STANDAD RESOLUTION		HIGH RESOLUTION	
	NTSC	PAL	NTSC	PAL
Number of Pixels	H 510 V 492	500 582	768 494	752 582
Scanning Frequency	H 15.734KHz V 59.94Hz	15.625KHz 50Hz	15.734KHz 59.94Hz	15.625KHz 50Hz
Horizontal Resolution	Color : 420 TV Lines B/W : 460 TV Lines	420 TV Lines 460 TV Lines	600 TV Lines 700 TV Lines	600 TV Lines 700 TV Lines

Image Pick-UP Device	1/3" Sony Super HAD II Color CCD
Scanning System	2:1 Interlace
S/N Ratio (AGC Off)	More Than 50dB
Min. Sensitivity	0.1 Lux (F 1.2)
Gamma Correction	0.45 Approx.
Gain Control	Automatic
Video Output	Composite Video 1.0Vp-p/75Ω
Lens	Pinhole Lens 3.7mm
Power Source	DC12V 500mA Regulated Power Supply
Power Sonsumption	MAX 2.0W
Operating Temp.	-10℃ ~ +50℃

Smoke Detector

Dimensions (mm)	125mm(D) x 53mm(L)
Weight/g	130g

Clock Camera

Dimensions (mm)	270mm(D) x 40mm(L)
Weight/g	600g

PIR Detector

Dimensions (mm)	62(W) x 90(H) x 48(D)
Weight/g	120g

※ Option - Audio
- Motion detector