

**CAUTION**RISK OF ELECTRIC SHOCK  
DO NOT OPEN

CAUTION : TO REDUCE THE RISK OF ELECTRIC SHOCK,  
DO NOT REMOVE COVER  
NOT USER SERVICEABLE PARTS INSIDE  
REFER SERVICING TO QUALIFIED SERVICE PERSONNEL

**Dimensions****Accessories**

Mount Screws

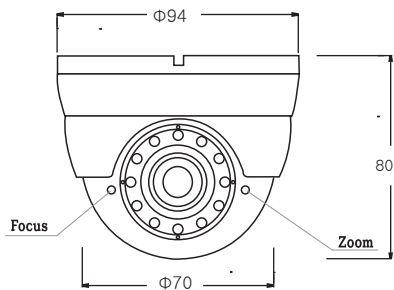
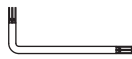

L-wrench

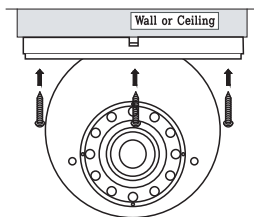
**Installation****Step.1**

Fix the base bracket  
with screws on the Wall or Ceiling

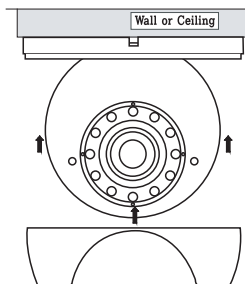
**Step.2**

Adjust ball angle  
and fix the ball base

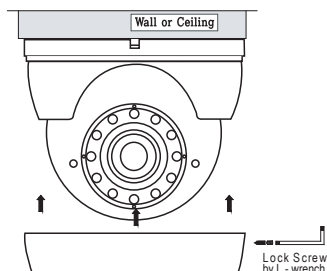
**Step.3**

Turn fix the dome cover on  
the base by hand  
and lock by L-wrench



CAUTION ! Please use regulated power supply DC12V  
Reverse Polarity Protection

**Features**

1/3" Sony Super HAD II Color CCD(600TVL)  
DNR(Digital Noise Reduction)  
DWDR(Digital WDR)  
12 IR LEDs with 850nm.  
IR Smart(Intelligent IR)  
Fixed Lens (4mm)  
Gimbal bracket  
Weatherproof.(IP-66)

**Specifications**

TV System	STANDAD RESOLUTION		HIGH RESOLUTION	
	NTSC	PAL	NTSC	PAL
Number of Pixels	H 510 V 492	500 582	768 494	752 582
Scanning Frequency	H 15.734KHz V 59.94Hz	15.625KHz 50Hz	15.734KHz 59.94Hz	15.625KHz 50Hz
Horizontal Resolution	Color : 420 TV Lines		Color : 600 TV Lines B/W : 700 TV Lines	
Image Pick-UP Device	1/3" Sony Super HADII Color CCD			
Scanning System	2:1 Interlace			
S/N Ratio	More Than 50dB			
Min. Sensitivity	0.1 Lux / 50IRE - at F : 1.4			
IR LED	12 pcs of IR LEDs 850nm			
Gamma Correction	0.45 Approx.			
Gain Control	Automatic			
Video Output	Composite Video 1.0Vp-p/75Ω			
Operating Temp.	-10°C ~ +50°C			
Operating Humidity	30% to 90%			
Power Source	DC12V 500mA			
Lens	Fixed Lens ( 4mm )			
Power Sonsumption	Max 2Watt at IR ON			
Dimensions (mm)	61mm(D) x 83mm(L)			
Weight/g	410			

Option: Lens 3.6mm