

### CAUTION

RISK OF ELECTRIC SHOCK  
DO NOT OPEN

CAUTION : TO REDUCE THE RISK OF ELECTRIC SHOCK,  
DO NOT REMOVE COVER  
NOT USER SERVICEABLE PARTS INSIDE  
REFER SERVICING TO QUALIFIED SERVICE PERSONNEL

## Dimensions

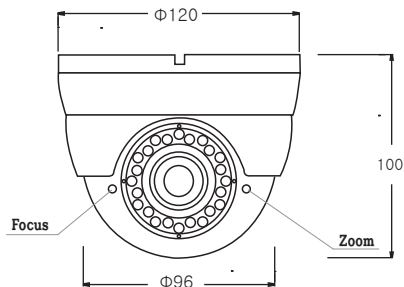

## Accessories



Mount Screws

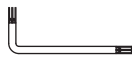

L-wrench



Zoom & Focus adjuster

## Installation

### Step.1

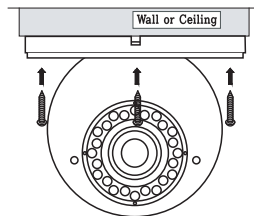

Fix the base bracket  
with screws on the Wall or Ceiling

### Step.2

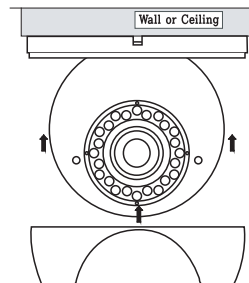

Adjust ball angle  
and fix the ball base

### Step.3

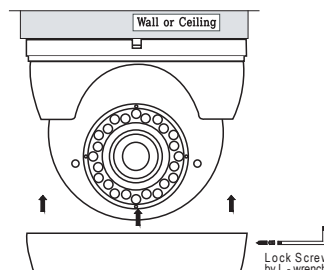

Turn fix the dome cover on  
the base by hand  
and lock by L-wrench



CAUTION ! Please use regulated power supply DC12V  
Reverse Polarity Protection

## Features

- 1/3" Sony Super HAD II Color CCD(600TVL)
- DNR(Digital Noise Reduction)
- DWDR(Digital WDR)
- 24 IR LEDs with 850nm.
- IR Smart(Intelligent IR)
- Varifocal Iris Lens (TDN 2.8 ~ 12mm)
- Gimbal bracket
- Weatherproof.(IP-66)

## Specifications

| TV System             | NTSC   | PAL       |
|-----------------------|--|-----------|
| Image pick-up Device  | 1/3" 410k Sony super HAD II Color CCD (600TVL) |           |
| Number of Pixels      | H 768  | 752       |
|                       | V 494  | 582       |
| Scanning Frequency    | H 15.734KHz                                    | 15.625KHz |
|                       | V 59.94Hz                                      | 50Hz      |
| Horizontal Resolution | Color : 600TV Lines                            |           |
| S/N Ratio             | More Than 50dB                                 |           |
| Min. Sensitivity      | 0.1 Lux - at F : 1.4                           |           |
| IR LED                | 24 LEDs IR, 850nm                              |           |
| Scanning System       | 2:1 Interlace                                  |           |
| Gamma Correction      | 0.45 Approx.                                   |           |
| Gain Control          | Automatic                                      |           |
| Video Output          | Composite Video 1.0Vp-p/75                     |           |
| Lens                  | Varifocal iris lens(TDN 2.8~12mm)              |           |
| Power Source          | AC24V 200mA / DC12V 300mA                      |           |
| Power Sonsumption     | MAX 3Watt at IR on                             |           |
| Operating Temp.       | -10°C ~ +50°C                                  |           |
| Operating Humidity    | 30% to 90%                                     |           |
| Dimensions (mm)       | 120mm(D) x 100mm(L)                            |           |
| Weight (g)            | 880g   |           |
| IP-rating             | IP-66  |           |

\*\*option : DC 2.8~12mm lens  
DC 4~9mm lens  
Manual 2.8~12mm lens